

PRELIMINARY TECHNICAL INFORMATION

GENERAL SPECIFICATIONS

Dimensions:	135x125 mm.
Material:	6063 (AlMgSi0,5)
Perimeter:	2502 mm
Section:	5430 mm ²
Weight:	14,66 kg./m.

TYPICAL Rth VALUES

RG07089/100N (*1)	0,6500 °C/W.
RG07089/120N (*1)	0,5000 °C/W.
RG07089/180N (*1)	0,4100 °C/W.
RG07089/300N (*1)	0,3500 °C/W.
RG07089/100F (*2)	0,2170 °C/W.
RG07089/120F (*2)	0,1670 °C/W.
RG07089/180F (*2)	0,1360 °C/W.
RG07089/300F (*2)	0,1160 °C/W.

*1: Natural convection, vertical fins & black anodised surface

*2: With fan 145m³/h (minimum)

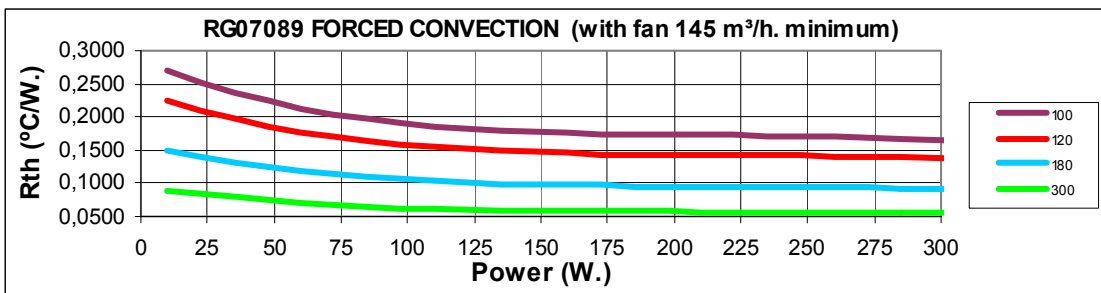
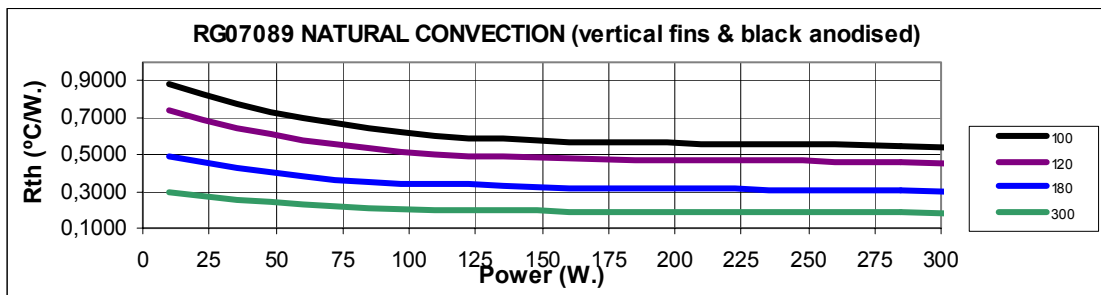
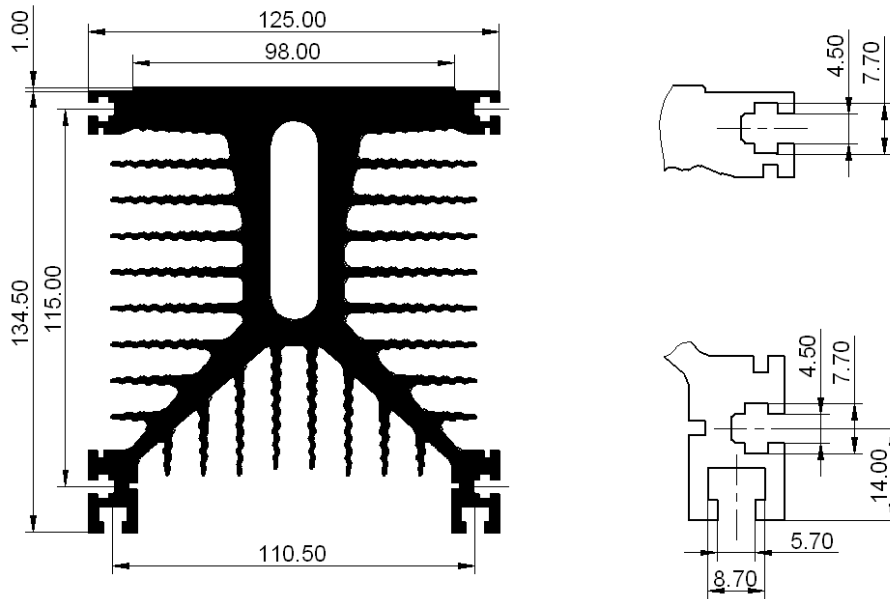

060209

The thermal resistance values are only standard values for large-area heat distribution. They are not suitable to replace measurements under field conditions

RECTIFICADORES GUASCH, S.A.

Ciutat de Granada, 80
08005 BARCELONA
SPAIN

Se reserva el derecho de cambiar los límites, las condiciones de prueba y dimensiones indicadas en esta hoja sin previo aviso.
Reserves the right to change limits, test conditions and dimensions given in this data sheet at any time without previous notice.

Tel.: +34 93 309 88 91
Fax: +34 93 300 18 41
e-mail: info@e-guasch.com
www.e-guasch.com